

ScissorLoc™ III

FLOATING SYSTEMS

Like all of the Aacer ScissorLoc systems, ScissorLoc III features an intersecting solid wood subfloor component design that creates a dimensionally stable system with excellent natural airflow. With it's high shock attenuation pad, ScissorLoc III provides the ultimate in shock absorption. It's excellent resiliency aids in reducing stress related injuries. This system is a good choice for aerobic floors, dance halls, and cardio kick boxing.



INFINITY
Wood Floors



ScissorLoc™ III

ScissorLoc™ III provides an intersecting subfloor design for premium airflow and uniform play.



1. Infinity MFMA Maple
2. Kiln-dried Pine Upper Subfloor
3. Kiln-dried Pine Upper Subfloor
4. 3/4" (19mm) TriPower Resilient Pad
5. PowerVent Airflow Option

WALL BASE

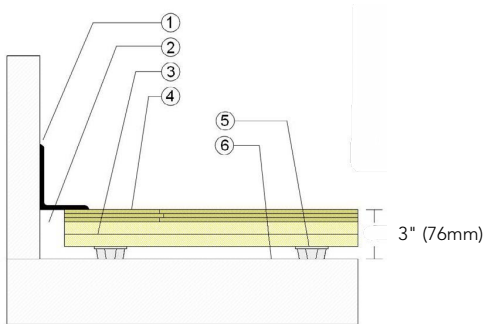

1. 3" x 4" (76mm x 101mm) Vent Cove Base
2. 1 1/2" (38mm) Min. Expansion Space
3. 3/4" x 5-1/2" (19mm x 140mm) Upper and Lower Pine Layers
4. 25/32" (20mm) MFMA Maple Flooring
5. 3/4" (19mm) Resilient TriPower Pad
6. Vapor Retarder

THRESHOLD

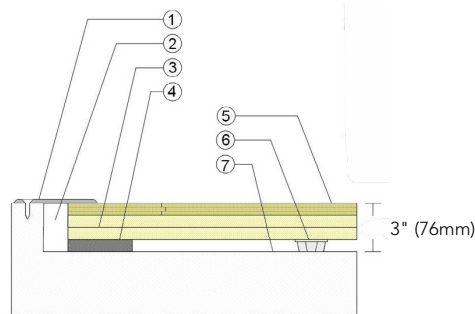

1. 1/4" (6mm) Aluminum Threshold
2. 1 1/2" (38mm) Min. Expansion Space
3. 3/4" x 5-1/2" (19mm x 140mm) Upper and Lower Pine Layers
4. Solid Blocking at Doorway
5. 25/32" (20mm) MFMA Maple Flooring
6. 3/4" (19mm) Resilient TriPower Pad
7. Vapor Retarder

EQUIPMENT

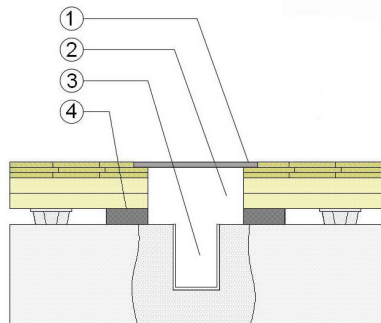

1. Floor Plate
2. 1 1/2" (38mm) Expansion Space at all Inserts and Electrical Penetrations
3. Concrete Floor Penetration
4. Solid Blocking at Insert

Green Status
and LEED
Contributors



- FSC® Certified Maple - MR
- FSC® Certified Subfloor Components - MR
- Environmental Quality - EQ
- Regional Materials - MR

Resilience

3/4" (19mm) TriPower Pad
*Other pad options available.

Slab
Depression

- 25/32" (20mm) flooring - 3" (76mm)

Optional
ScissorLoc™
Systems

ScissorLoc™ I
ScissorLoc™ II
ScissorLoc™ LP

Optional
Accessory

PowerVent™ Airflow System

Subfloor
Construction

Intersecting Kiln-dried Solid Pine

System Type

Floating

Testing
Laboratory
Partners



U.S. Patent #

#5,299,401

It is the policy of Infinity Wood Floors to continuously improve its line of products. Therefore, Infinity Wood Floors reserves the right to change, modify or discontinue systems, specifications and accessories of all products at any time without notice or obligation to purchaser.



see us at
Sweets.com

